

# Floor Plan • Texas Bunk House

Texas Bunk House / Bath  
Includes Foundation

**greentech** technology

Approximately 200 Square Feet

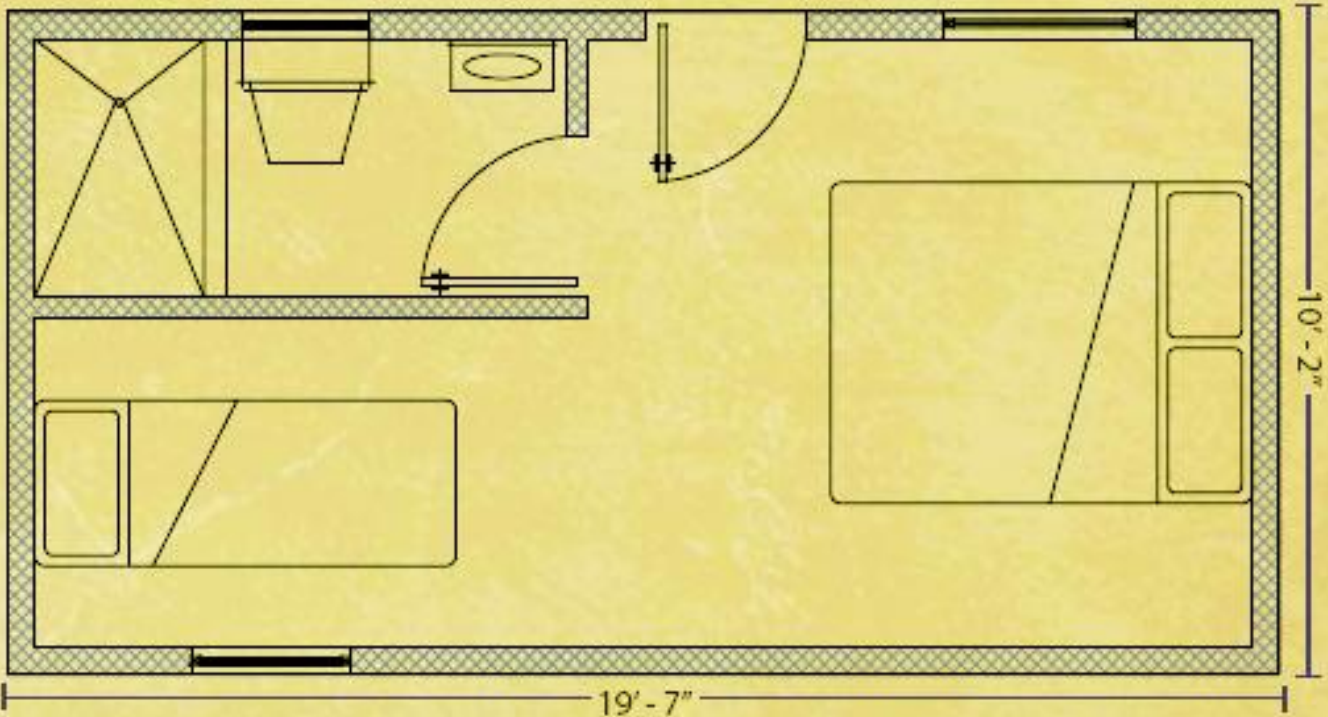

## Foundation Elevation View

- 12" wide x 24" deep concrete perimeter beam foundation
- Foundation will over hang 4" past the home
- Concrete mix is 3000 psi
- 4 sticks of 1/2" rebar up & down
- Foundation extends 4" above grade & 20" below grade
- Home is permanently anchored into foundation

